

Sheaves

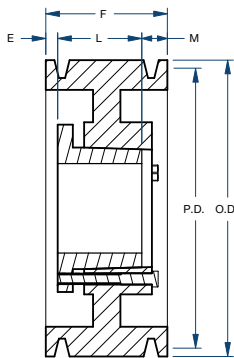

BLACKSTAR®

5V SERIES 2 GROOVE/QD



Type A

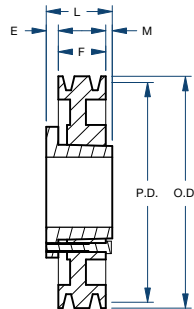

Type C

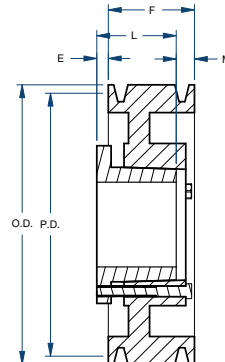

Type D

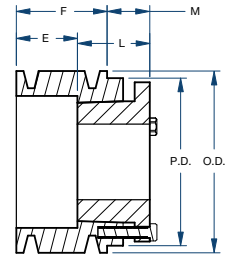

Type E

Part Number	Bushing	Bore Range	Type	Diameter (in)		Dimensions (in)				Weight less Bushing (lbs)
				Pitch	Outside	E	F	L	M	
2-5V440SH	SH	1/2 – 1-5/8	D	4.30	4.40	11/32	1-11/16	1-5/16	23/32	5.8
2-5V465SDS	SDS	1/2 – 2	E	4.55	4.65	27/32	1-11/16	1-5/16	15/32	6.6
2-5V490SDS	SDS	1/2 – 2	A	4.80	4.90	1/32	1-11/16	1-5/16	11/32	6.8
2-5V520SDS	SDS	1/2 – 2	A	5.10	5.20	1/32	1-11/16	1-5/16	11/32	7.0
2-5V550SDS	SDS	1/2 – 2	A	5.40	5.50	1/32	1-11/16	1-5/16	11/32	7.2
2-5V590SDS	SDS	1/2 – 2	A	5.80	5.90	1/32	1-11/16	1-5/16	11/32	7.6
2-5V630SK	SK	1/2 – 2-5/8	D	6.20	6.30	11/32	1-11/16	1-15/16	3/32	9.4
2-5V670SK	SK	1/2 – 2-5/8	D	6.60	6.70	11/32	1-11/16	1-15/16	3/32	10.5
2-5V710SK	SK	1/2 – 2-5/8	D	7.00	7.10	11/32	1-11/16	1-15/16	3/32	11.5
2-5V750SK	SK	1/2 – 2-5/8	D	7.40	7.50	11/32	1-11/16	1-15/16	3/32	12.5
2-5V800SK	SK	1/2 – 2-5/8	D	7.90	8.00	11/32	1-11/16	1-15/16	3/32	13.0
2-5V850SK	SK	1/2 – 2-5/8	D	8.40	8.50	11/32	1-11/16	1-15/16	3/32	14.0
2-5V900SK	SK	1/2 – 2-5/8	D	8.90	9.00	11/32	1-11/16	1-15/16	3/32	15.2
2-5V925SK	SK	1/2 – 2-5/8	D	9.15	9.25	11/32	1-11/16	1-15/16	3/32	15.3
2-5V975SK	SK	1/2 – 2-5/8	D	9.65	9.75	11/32	1-11/16	1-15/16	3/32	15.5
2-5V1030SK	SK	1/2 – 2-5/8	D	10.20	10.30	11/32	1-11/16	1-15/16	3/32	15.5
2-5V1090SK	SK	1/2 – 2-5/8	D	10.80	10.90	11/32	1-11/16	1-15/16	3/32	16.5
2-5V1130SK	SK	1/2 – 2-5/8	D	11.20	11.30	11/32	1-11/16	1-15/16	3/32	17.8
2-5V1180SK	SK	1/2 – 2-5/8	D	11.70	11.80	11/32	1-11/16	1-15/16	3/32	19.0
2-5V1250SF	SF	1/2 – 2-15/16	D	12.40	12.50	13/32	1-11/16	2-1/16	1/32	21.0
2-5V1320SF	SF	1/2 – 2-15/16	D	13.10	13.20	13/32	1-11/16	2-1/16	1/32	22.6
2-5V1400SF	SF	1/2 – 2-15/16	D	13.90	14.00	13/32	1-11/16	2-1/16	1/32	25.3
2-5V1500SF	SF	1/2 – 2-15/16	D	14.90	15.00	13/32	1-11/16	2-1/16	1/32	27.4
2-5V1600SF	SF	1/2 – 2-15/16	D	15.90	16.00	13/32	1-11/16	2-1/16	1/32	29.2
2-5V1870SF	SF	1/2 – 2-15/16	D	18.60	18.70	13/32	1-11/16	2-1/16	1/32	36.0
2-5V2120SF	SF	1/2 – 2-15/16	D	21.10	21.20	13/32	1-11/16	2-1/16	1/32	43.0
2-5V2360E	E	7/8 – 3-1/2	C	23.50	23.60	29/32	1-11/16	2-3/4	5/32	55.0
2-5V2800E	E	7/8 – 3-1/2	C	27.90	28.00	29/32	1-11/16	2-3/4	5/32	67.0